

RoHS

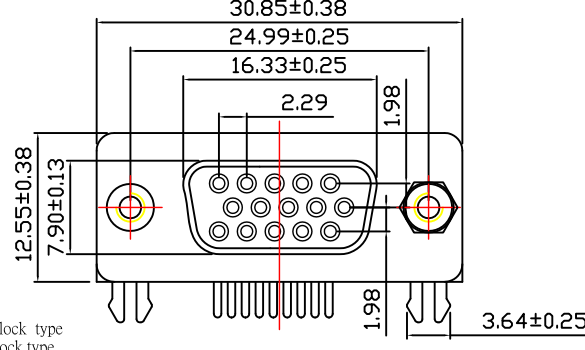

(26~62PIN)

15PIN

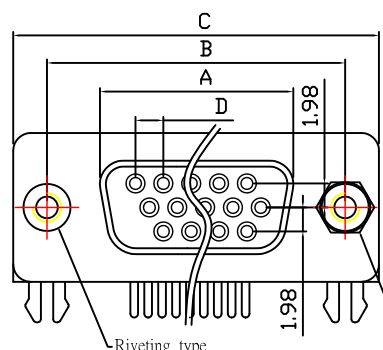
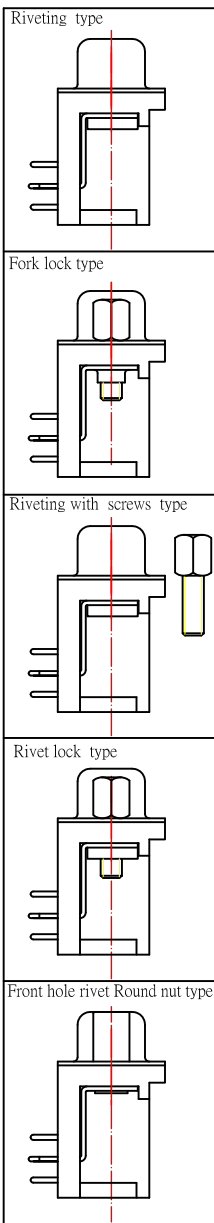
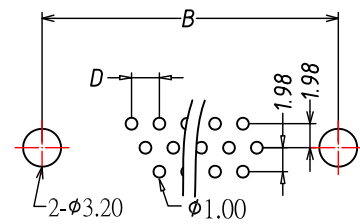
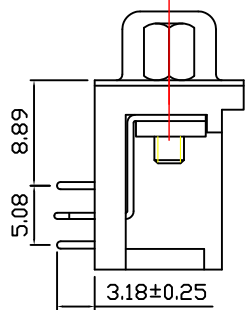
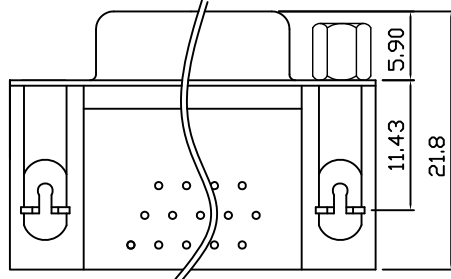

P.C BOARD LAYOUT (26~62PIN)

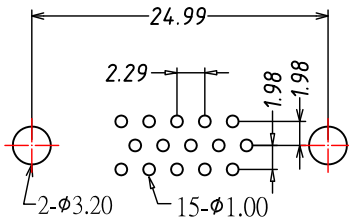

P.C BOARD LAYOUT 15PIN

Table 1

NUMBER OF CONTACTS	A	B	C	D
	±0.25	±0.25	±0.38	±0.08
15	16.33	24.99	30.85	2.29
26	24.66	33.32	39.14	2.29
44	38.38	47.04	53.04	2.29
62	54.84	63.50	69.32	2.41

SPECIFICATIONS:
ELECTRICAL SPECIFICATION

Contact Current Rating: 3 Amperes
Dielectric Withstanding Voltage: AC 1000/60ses.r.m.s.
Insulation Resistance: 5000 Megohm Min. at DC 500V
Contact Resistance: 25 milliohm Max.
Operating Tempetature: -55°c ~ +105°c

MATERIALS:

Contacts: Brass or Phosphor bronze
Contacts: See number description
Insulator: PBT+G.F UL94V-0
Shell: Steel or Stainless steel

PART NO:

ZHR F15 F E 1 B G N 3 0
1 2 3 4 5 6 7 8 9 10

- D-SUB Female Three Row Right Angle Type(Stamped PIN) 7 · Accessories :
- Board lock material: 0 : No accessories
A: With iron hexagon screw, 4.8*11.8mm
B: With brass hexagon screw, 4.8*11.8mm
E : Lock brass hexagon screw, 5.8*12.8mm
G: Lock iron hexagon screw, 4.8*11.8mm
J : Lock iron hexagon screw, 5.8*12.8mm
K : Lock brass hexagon screw, 4.8*11.8mm
- Contact No. :
15=15PIN 26=26PIN
44=44PIN 62=62PIN
- Contact Type:
F=Female type, Brass (stamped PIN) 8 · Shell material and Plating:
N=SPCC, Plating nickel
D= Stainless steel, Passivation
C=Stainless steel, Plating nickel
T=SPCC, Plating Tin
- Contact plating :
See table 2
- Assembly :
A=Fork lock type
B=Riveting type
F=Front hole rivet Round nut type, 6.0mm 9 · Color :
1=White
2=Blue
3=Black
- Remark:

Table 2

Gold Plated			Selective Gold Type		
CODE	Contact Area	Other Area	CODE	Contact Area	Other Area
C1	Gold Flash	Gold Flash	E1	Gold Flash	Tin plated
C2	Gold 3u"	Gold Flash	E2	Gold 3u"	Tin plated
C3	Gold 10u"	Gold Flash	E3	Gold 10u"	Tin plated
C4	Gold 15u"	Gold Flash	E4	Gold 15u"	Tin plated
C5	Gold 30u"	Gold Flash	E5	Gold 30u"	Tin plated

DSND	HUANGJM	DATE	2011-12-01	SCALE:	
CHKD				VIEW:	
APVD				UNIT:	mm

NAME:
D-SUB P.C.B Female Three Row Right Angle Type(Stamped PIN)

Part No: ZHRXXXFXXXXXXX

Customer Part NO:(DWG NO.)



Dongguan Fushu Electronic Technology Co., Ltd
Tel: 0755-81765247/41 Fax: 0769-81765203

unless otherwise specified tolerance:
. X ± .38,
. XX ± .25,
. XXX ± .15,
ANG ± 2°

MARK	DESCRIPTION	DATE	REVISED	APPROVED

REVISIONS